

STUCCO

- This handout is intended only as a guide. It shall not be considered a complete set of requirements.
- Materials and installation must comply with the current Minnesota State Building Code and the manufacturers' installation specifications for each product.
- Stucco installation, repair, or demolition work on any structure is not classified as maintenance work. A building permit is required to:
 - Remove existing stucco (even when residing with material other than stucco)
 - Apply new stucco
 - Repair existing stucco
- Each address requires a separate permit

BUILDING Permit Submittal shall include:

- Building Permit Application**, completed in its entirety, including signature and valuation.
- One set of plans** showing materials and application design, including:
 - Materials list
 - Scope of Work
 - Elevation view showing location of work
- Additional information may be required by the plan reviewer.

PERMIT CARD AND APPROVED PLANS (throughout the project) shall be:

POSTED prior to start of work - **VISIBLE** from street or driveway - **ACCESSIBLE** to the inspector.

INSPECTION REQUIREMENTS:

Inspections **MUST** be scheduled during office hours **AT LEAST** one business day prior to inspection. If a specific date and time is required, additional notice may be needed. Failure to cancel a scheduled inspection may result in a reinspection fee.

- **Office Hours:** Monday - Friday • 8:00 a.m. - 4:30 p.m.
- **Phone:** (952) 442-7520 or (888) 446-1801

Inspections: (Refer to your permit card regarding project-specific inspections)

- **Initial tear off (demo):** After all existing stucco is removed and before anything is covered.
- **Lath:** After lath, weep screed, paper, and kick-out flashing are applied, **before brown coat**. More than one lath inspection may be required; however, if a project is done in stages and more than three inspection trips are needed, a reinspection fee may be charged on the fourth inspection visit.
- **Final:** When all work is complete.
- The building official may require additional inspections.

NOTICE: Construction or work for which a permit is required shall be subject to inspection by the Building Official, and such **construction or work shall remain accessible and exposed for inspection purposes until approved**. It is the responsibility of the permit applicant to be in attendance on site and provide access to the Building Official for all required inspections. If work is concealed and/or work is not complete at time of inspection, an additional inspection is required and a **reinspection fee may apply**.

Note: The State of Minnesota requires all residential building contractors, remodelers, roofers, plumbers, and electricians to obtain a state license, unless they qualify for a specific exemption. Any person claiming an exemption must provide a copy of a Certificate of Exemption from the Department of Labor & Industry to the Municipality before a permit will be issued.

Note: To determine contractor requirements, or to check the licensing status of a contractor, please call the Minnesota Department of Labor & Industry at 651-284-5065 or toll free 1-800-342-5354.

Note: For specific code requirements, contact the Building Inspection Department at 952-442-7520 or 888-446-1801 or e-mail: info@mnspect.com.

PROJECT CHECKLIST:

The following is a guideline to assist in compliance with the requirements of the MN State Building Code.

- The home address must be visible from the street.
- Installation of exterior plaster shall be in compliance with ASTM C926-98a and ASTM C1063.99 and the provisions of the MN State Building Code.
- Vertical joints in paper shall be lapped at least 6 inches and horizontal joints shall be lapped at least 2 inches (R703.2).

- (R703.7.3) Weather resistive barriers over wood base sheathing shall include 2 layers of water-resistant vapor-permeable barrier. Each layer shall meet both of the following requirements:
 - 1.) A water resistance not less than that of 60-minute Grade D paper
 - 2.) A water vapor permeance not less than that of No. 15 felt.
- Self-furring lath installed over paper and weep screed.
- A corrosion resistant weep screed with a minimum vertical attachment flange of 3 ½ inches shall be provided at or below the foundation plate line on all exterior stud walls. The screed shall be placed at minimum of 4 inches above the earth or two inches above paved areas and shall be of a type that will allow trapped water to drain to the exterior of the building.
- Stucco must cover, but not extend below, the lath and paper for slab on grade construction.
- Fasteners for metal lath must be 6 inches on center at supports, and must be corrosion resistant.
- Paper must be installed shingle fashion.
- Nailing flanges on windows shall not be accepted as drip-cap flashing unless the manufacturer's installation instructions are provided stating that the flange is acceptable as flashing.
- Exterior penetrations (windows, deck ledgers, pipe and vent penetrations, etc.) shall be weatherproofed.
- Kick-out flashing is to be installed at wall/roof intersections where the roofline does not extend past the wall.
- Stop bead or stucco stop is required at the intersection of all dissimilar building materials (i.e. wood trim, windows).
- When electrical wiring is penetrating metal lath, there must be an annular space around the wire and lath of 1".

FLASHING: (R703.4) Shall be corrosion-resistant and installed at:

- Window and door openings.
- Intersection of chimney and stucco wall
- Wall / roof intersections
- Material changes

WRB: (R703.7.3) Weather resistive barriers (WRB) over wood base sheathing shall include 2 layers of water-resistant vapor-permeable barrier. Each layer shall meet both of the following requirements:

- A water resistance not less than that of 60-minute Grade D paper
- A water vapor permeance not less than that of No. 15 felt
- (R703.2) Lap paper: horizontal 2 inches min., Vertical 6 inches min.

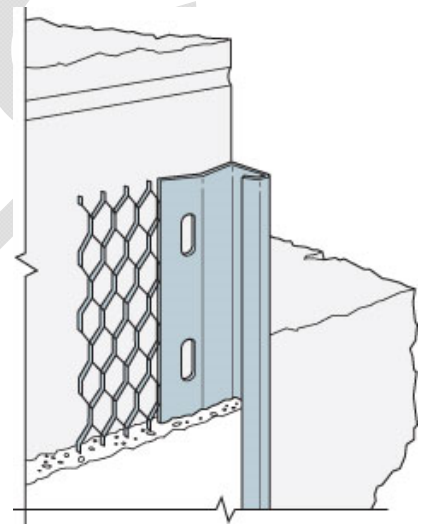

Lath: (R703.7.1)

- All lath and lath attachments shall be of corrosion-resistance materials.
- Lath shall be attached with 11-gage nails having 7/16" head or 16-gage staples spaced 6" max. Nails or staples shall penetrate wood framing members ¾" minimum.

Weep Screed: (R703.7.2.1)

- No. 26 galvanized steel corrosion-resistant or plastic weep screed.
- Vertical attachment: 3-1/2" min. at or below foundation plate.
- Min 4-inches above ground, or 2" min above hardscape.
- The exterior lath and the WRB shall cover and terminate on the attachment flange of the weep screed.

Stucco:

- Must conform to ASTM C926 & C1063
- 3-coat system (Scratch, brown, and finish coat) when applied over metal or wire lath.

